

Simonds

OWNER & SAFETY MANUAL

SP-008 | SP-008F POWER PACK



LENGTH	142.87 mm (5.63")
WEIGHT	963.9 gram (2 lb. 2 oz.)
DIAMETER	73.02 mm (2.88")
CFM@30 STROKES MIN.	0.0155 m ³ (0.55 cfm)
CLOSING FORCE @5.516 BAR (80 PSI)	Finish—691.3 kilogram (5000 lb)
CAM	HEXAGON
MATERIAL	ALUMINUM



Made in the U.S.A.



Read Carefully Before Operating



Wear Eye Protection

SIMONDS INC.
248 ELM ST. | SOUTHBRIDGE, MA 01550
508-764-3235 | sales@simonds-inc.com | www.simonds-inc.com

SP-008 PARTS BREAKDOWN

• SA-1-008
PISTON HOUSING
ASSEMBLY

• SA-4-008 VALVE ASSEMBLY
(not included in foot model)

• SA-3-008 PISTON SHAFT ASSEMBLY

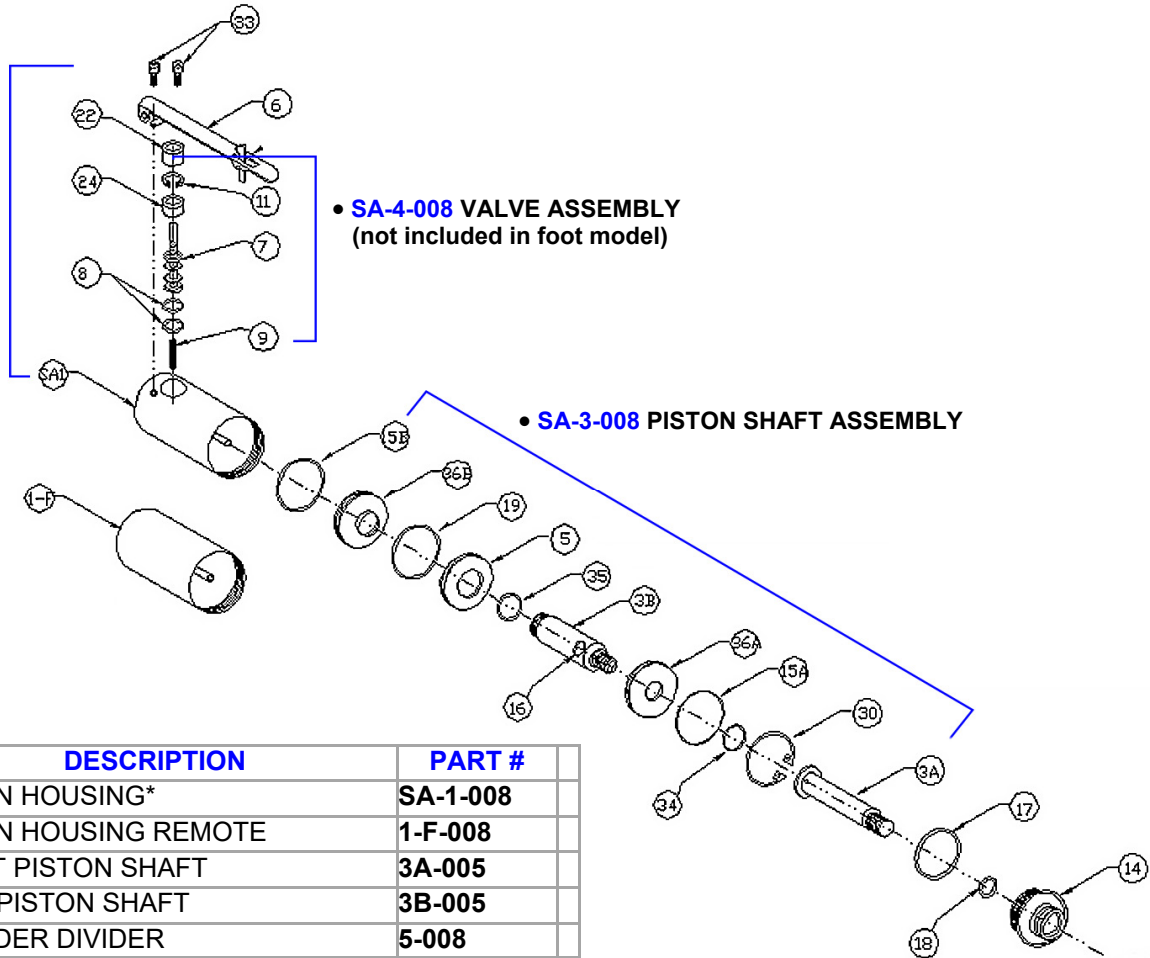

#	DESCRIPTION	PART #	
SA-1	PISTON HOUSING*	SA-1-008	
1-F	PISTON HOUSING REMOTE	1-F-008	
3A	FRONT PISTON SHAFT	3A-005	
3B	REAR PISTON SHAFT	3B-005	
5	CYLINDER DIVIDER	5-008	
6	SAFETY LEVER ASSEMBLY	DA-1	
7	SPOOL	7-008	1
8	SPOOL O'RING (2 required) (KIT of 10)	16-003-K10	1
9	SPOOL SPRING	9A-01	1
11	SNAP RING	11-01	1
14	END CAP	14-008	
15A	FRONT PISTON SEAL	15A-008	
15B	REAR PISTON SEAL	15B-008	
16	PISTON SHAFT O'RING (KIT of 10)	16-003-K10	
17	O-RING (KIT of 10)	17-008-K10	
18	O-RING	18-005	
19	DIVIDER SEAL (KIT of 10)	17-008-K10	
22	VALVE SPACER	22-02	1
24	VALVE SPACER	24-008	1
25-H	HEX CAM	25-H	
30	PISTON SNAP RING	30-008	
33	LEVER SCREW (2 required)	28-01-K10	
34	PISTON SHAFT O'RING	18-01	
35	PISTON SHAFT O'RING	35-005-K10	
36A	FRONT PISTON PLATE	36A-008	
36B	REAR PISTON PLATE	36B-008	
	VALVE REPAIR KIT	SA-4-008	

(1) Included in the valve repair kit.

- Optional Cams available, for use with special tools: 25-C-800, 25-F, 25-S, 25-R, 25-C
- Two hoses included with FOOT models, one with HAND models

ASSEMBLY

- Upon receipt inspect box for all parts.
 - Screw on separate head. This should go on hand tight and should line up with air lever.
 - Prior to use attach air hose to air inlet of power pack using proper wrench size. Check that all threads are free of debris.
 - Attach air hose to Air filter/ regulator using a quick disconnect device. Be sure that air hose is secure. There should be no air leaks. If there is, remove hose and check threads for damage. Reattach air hose, tighten.
- ISOLATE AIR WHILE ATTACHING HOSE AND JAW HEAD!**
- Test unit to assure free movement of jaws. Be sure to follow all safety instructions when testing.
 - Once unit has been tested and safety issues addressed the unit is ready for production line use.

OPERATING INSTRUCTIONS:

- Maximum inlet pressure is **90 PSI** (5.516 BAR). The power pack needs to have an inline locking regulator so that maximum inlet pressure is not exceeded. Minimum air pressure is 40 PSI (2.758BAR).
For longer tool life it is recommend to use only enough air to complete the job, never exceeding the recommended pressure.
- Tools should have an in line air filter to remove debris, water and particulates. Inline air filter and regulator should be not more than 6 feet (1.83 m) from the tool.
- An inline lubricator will help to extend the life of the tool. Only use pneumatic oil recommended by Simonds in the lubricator. If no lubricator is available place a few drops of pneumatic oil in to the air inlet of tool each week.
- To activate unit, slide safety lever over with thumb and squeeze lever. Be sure to release start and stop device in case of a failure of energy supply.
- Air hose must be securely fastened to the air inlet prior to using. Be sure hose is tightened using the proper tool. The air hose needs a 1/8" (.25 mm NPT) thread attached that will screw in to the tool end.
- Air hose should be attached to air supply (air filtration system) securely. It is recommended that a quick disconnect devise be used to attach air hose to air supply.

SAFETY INSTRUCTIONS

- Inspect tools and hoses each day prior to operation. Air hose that is frayed, cut or abraded should be replaced. Be sure that threads are clean and not worn.
- If the tool is not in use and not positively disconnected from the energy supply, the energy supply system must facilitate isolation and dissipation of pressure by a suitable and lockable shutoff device in order to prevent unexpected start-up.
- Beware of hair, fingers, ties, loose clothing etc. when operating the tool. Keep away from moving parts.
- Always wear eye protection when operating the tool. Beware of ejection of cuttings or chips. Turn head to avoid being exposed to this operation.
- Beware that working on brittle material may cause harmful splinters.
- Always disconnect from air supply when changing tool, during repair, adjusting and inserting tools, maintenance and cleaning operations.
- Simonds tools are not designed for use in explosive atmospheres.
- Simonds tools are not insulated for coming in to contact with electric power sources.
- Do not use tools near personnel where risk of flying debris may hit them.
- Do not point or aim tool at another person.
- Unsecured or cut air hose may cause a whipping action which may result in injury.
- Do not use any attachments not manufactured by Simonds for this tool. Injury may result.
- If the tool is used on a bench stand or a work station be sure that the tool is fastened properly.
- Dispose of tool and material as recommended by local disposal regulations.
- Simonds tools are not for use other than on production line. Tool should not be used as a hammer or pry bar. A “two hand control” may be required depending on the attached tool.
- **DO NOT EXCEED RECOMMENDED WIRE SIZE OR AIR PRESSURE.** Exceeding the recommended wire size for the jaws may cause damage to tool or injury to user.

WARRANTY

Simonds Inc. power packs and jaws are warrantied to be free from defects in materials and workmanship for a period of one year, barring alterations, abuse or misuse. All products returned for warranty repair must be sent to Simonds Inc., Southbridge, MA at end users expense. Simonds will either repair or replace the tool if it is found defective due to material defect or workmanship at Simonds discretion.

Warranty repairs accepted only through distributors with proper RMA's.